

Hand winch stacker with automatic friction brake, capacity Kg. 300

Immagini Prodotto

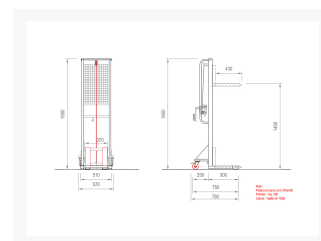

Descrizione

Capacity Kg 300

Weight Kg.56

Lifting height mm 1.580

Cable breaking load 1.000 kg

Push handles

Sizes:

Length mm 1.000

Total width mm 530
Minimum overall height mm 1.970
Maximum overall height mm 1.970
Length of fixed legs mm 600
Forks:
Length mm 600
Width mm 80
Thickness mm 50
Inner distance between forks mm 200
2 back wheels in Nylon/polyurethane Ø 150
1 with brake
2 Nylon front rollers Ø 80x40
Turning radius Wa mm 930
COMPLIANT TO CE RULES

Informazioni Aggiuntive

| | |
|----------------------|--------------------------|
| Cod. Prod. | ARX124 |
| Fornito | Montato - Pronto all'uso |
| Weight kg | 74.0000 |
| Plate | 370x430 |
| Load Capacity | 300 |
| Diametro Ruota in mm | 100 |
| Type of Wheel: | Ghisa poliuretano |
| Colour | Yellow RAL028 |
| Manufacturer | Carmeccanica |
| Made in | Italia |
| Warranty | 5 Years |
| Conformità | CE |
| Lead Time | Su Richiesta |