

Hand winch stacker with automatic friction brake, with assembly loadiplate

Immagini Prodotto

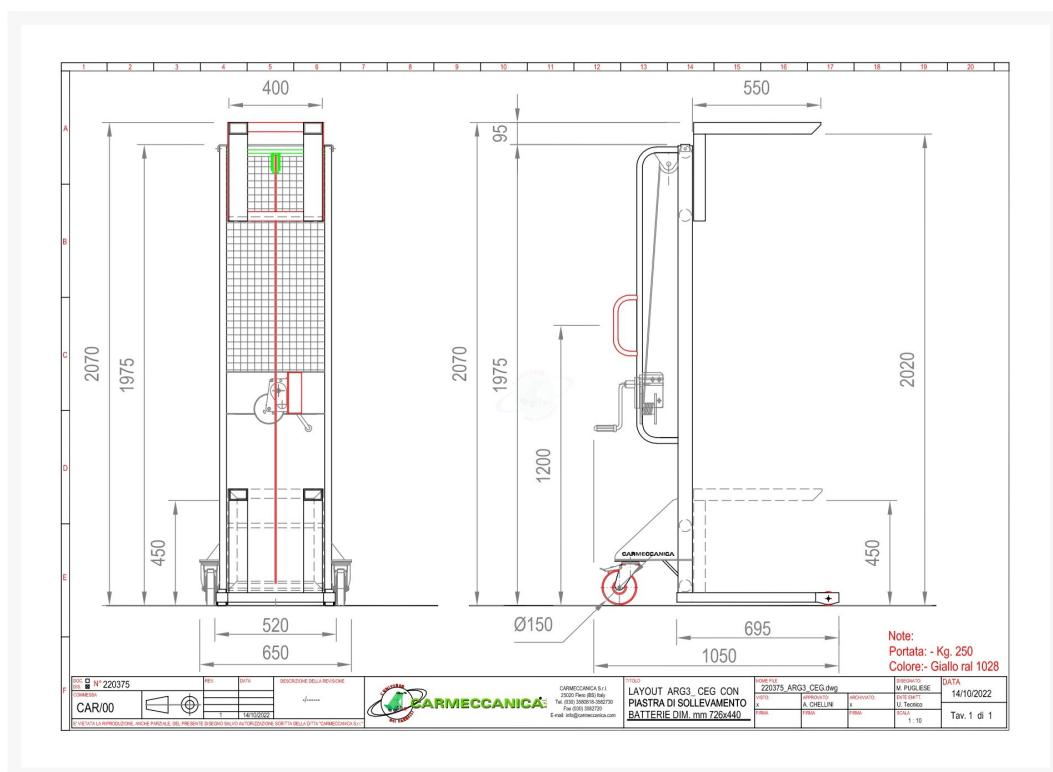

Descrizione

Push handle.

Hand winch AL.KO 450 with automatic frictino brake
 cable braking load 1000 kg

The load can only be lowered through a direct operation on the winch
 COMPLIANT TO CE RULE

DESCRIPTION

Lift

Hand winch

Drive	Pedestrian
Capacity	kg 300
Capacity with the applied loading plate	kg 250

SIZES

Lift height	mm 2000
Minimum overall height	mm 2070
Maximum overall height	mm 2070
Minimum plate height	mm 450
Overall length	mm 1050
Length to face of forks	mm 355
Total width	mm 650
Loading Plate length	mm 500
Loading plate width	mm 780

WEIGHT

Weight	kg 73
Wheel (front / rear)	2/2
Front roller	80x40
Rear Casters	150x45
Thread front	mm 520
Thread rear	mm 650

Informazioni Aggiuntive

Cod. Prod.	ARX183
Fornito	Montato - Pronto all'uso
Weight kg	0.0000
Load Capacity	300
Diametro Ruota in mm	150
Colour	Grey RAL7042
Manufacturer	Carmeccanica
Made in	Italia
Warranty	5 Years
Conformità	CE
Lead Time	Su Richiesta