

Self propelled stacker, capacity 1200

Immagini Prodotto

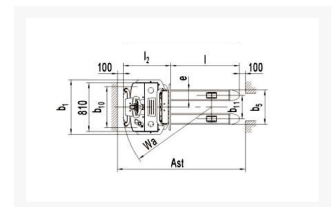
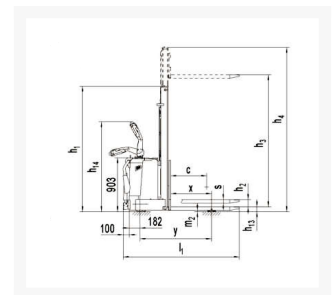

Descrizione

TNBEXS

12/29

FEATURES

Capacity	Q	Kg	1.200
Load center distance	C	mm	600
Drive			Fold down rider platform

SIZES

Lifting height	h3	mm	2.820
Free lift		mm	1.520
Overall fork length	l	mm	1.150
Width over forks	b5	mm	570
Fork width x thickness	e7s	mm	180/60
Overall length (TOEPLATE closed)	l1	mm	1.908
Length to front face of forks	l 2	mm	758
Width	b 1	mm	890
Minimum height	h1	mm	1.976
Maximum overall height	h 4	mm	3.276
Turning radius	Wa	mm	1.280
Tiller height MAX/min	h 14	mm	1.320/940
Minimum fork height	h 13	mm	81
Working aisle pallet 800x1200	AST	mm	2.158

PERFORMANCES

Drive speed loaded/ unloaded		Km/h	5.2/5.5
Lifting speed loaded/unloaded		mm/s	110/170
Lowering speed loaded/ unloaded	y	mm/s	120/130

Gradeability loaded/unloaded

CHASSIS

Wheels number drive end/ load end	nr	2+1M/4
Polyurethane stabilizer caster	mm Ø	150x54
Drive wheel	mm Ø	252x89
Nylon front rollers	mm Ø	80x70
Wheelbase	y mm	1.278
Truck width drive end	b 10 mm	650
Truck width load end	b 11 mm	390

MOTOR

Drive motor s2 60 min	Kw	1.3
Lifting motor s3 15%	Kw	2.2
Drive control		MOSFET
Battery	V/Ah	24/210

WEIGHT

Weight unloaded	Kg	910
Weight battery	Kg	185

RECTIFIER

Charger	V-A	24-40
---------	-----	-------

Informazioni Aggiuntive

Cod. Prod.	TNBEXS 12/29
GTIN/EAN	8053853156259
Fornito	Montato - Pronto all'uso
Weight kg	910.0000
Load Capacity	1200
Type of Wheel:	-
Colour	Red RAL3000
Manufacturer	Carmeccanica
Warranty	2 Years
Conformità	CE
Lead Time	15 giorni