

Self propelled stacker

Immagini Prodotto

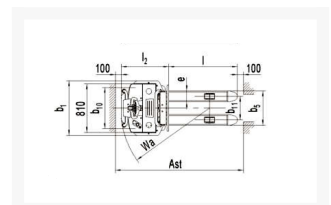
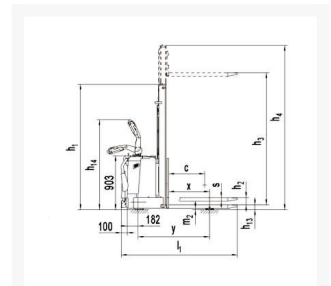

Descrizione

FEATURES

	Q	Kg	TNBEX
Capacity			1.200
Load centre distance	C	mm	600

TNBEX
12/32

Distance load axle to end forks	X	mm	684
Wheelbase	Y	mm	1181
Operator type			Pedestrian
Rider platform and protective arm			YES

WEIGHT

Service weight		kg	960
Axle load laden front		kg	820
Axle load unladen front		kg	720
Axle load laden rear		kg	1310
Axle load unladen rear		kg	210

SIZES

Lifting height	h3	mm	3200
Full free lift		mm	120
Forks length	l	mm	1150
Distance between fork arms	b5	mm	570
Fork dimensions width x thickness	e/s	mm	180x60
Overall length (excluding rider platform)	l1	mm	1845
Length to face of forks	l2	mm	695
Overall width	b1	mm	912
Height, mast lowered	h1	mm	2096
Height, mast extended	h4	mm	3975
Turning radius	Wa	mm	1400
Height of tiller MAX/min	h14	mm	1420/985
Lowered fork height	h13	mm	81
Ground clearance, center of wheelbase	m2	mm	26
Aisle width pallet 800x1200	AST	mm	2215

PERFORMANCES

Travel speed laden / unladen		Km/h	6,0/6,0
------------------------------	--	------	---------

Lift speed laden / unladen		mm/s	0,105/0,15
Lowering speed laden / unladen		mm/s	0,13/0,11
Gradeability laden / unladen		%	6/12

FRAME

Wheels number front / rear (M=driving wheel)		nr	2+1M/4
Tyres: stabilizers wheels		mm Ø	150x54
Driving wheel		mm Ø	252x8
Nylon front rollers		mm Ø	80x70
Wheelbase	y	mm	1.196
Tread, front	b10	mm	686
Tread, rear	b11	mm	390

Electric motor

Drive motor power s2 60min		Kw	1,3
Lift motor power s3 15%		Kw	2,2
Drive control			AC speed control
Battery		V/Ah	24/210
Battery weight		Kg	200

CHARGER

Charger		V-A	24-40
---------	--	-----	-------

Informazioni Aggiuntive

Cod. Prod.	TNBEX 12/32
GTIN/EAN	8053853156235
Fornito	Montato - Pronto all'uso
Weight kg	960.0000
Type of Wheel:	-
Colour	Red RAL3000
Manufacturer	Carmeccanica
Warranty	1 Year
Conformità	CE
Lead Time	Esaurito