

# Single cylinder truck 5/7 lt.

## Immagini Prodotto

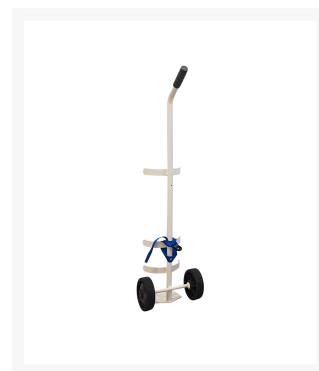

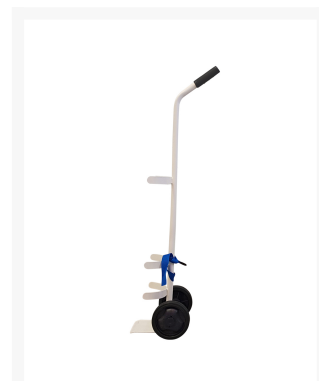
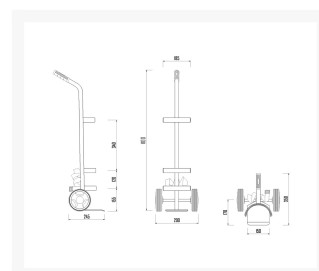

## Descrizione

---

Single cylinder truck for Ø 160 cylinder, capacity lt. 10/14.

Designed for a professional user, ideal for both industrial and hospital use.

Welded cylinder supports at 3 different heights and a strap with buckle ensure greater stability.

2 Injection rubber wheel Ø 150 polypropylene centre, rolling on plain bore

Hand truck suitable for stoneware, asphalt, concrete and resin.

**Sizes** 290x350x1100 mm

**Round cylinder holders height** mm 155 - 275 - 615

**Noseplate sizes** 150x150 mm

**Weight** Kg.3,5

**Capacity** 60 Kg

Belt with 70 cm blue buckle.

Non-toxic rubber knobs.

Ergonomic handle.

Electro-welded tubular, plate and rims.

EPOXY POWDERS COATED

COMPLIES WITH CE STANDARDS

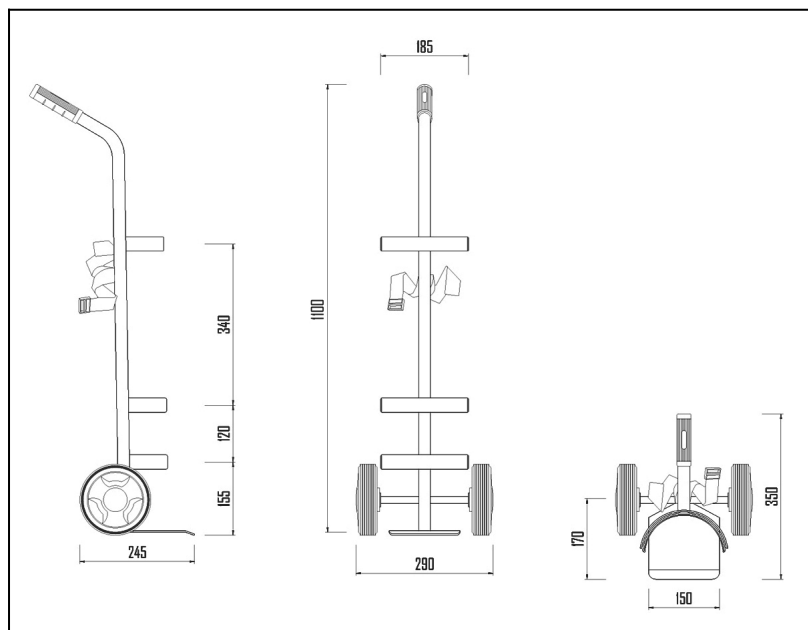

## Informazioni Aggiuntive

Cod. Prod.	ART032A
GTIN/EAN	8053853151148
Supplied	Fully assembled
Weight kg	3.5000
Plate	150x150
Load Capacity Kg	60
Casters diameter mm	150
Type of Wheel:	Nylon
Colour	White RAL9010
Manufacturer	Carmeccanica
Made in	Italia
Warranty duration	5 Years
Conformity	CE
Lead Time	Pronta Consegna